

**KEIPER synchronizing toothed shafts**

can be made of such different materials as aluminum, steel or stainless steel.

The fact that they can be produced with all pitches and designed according to your specifications and drawing ensures optimal solutions for all applications and any loads.

Our synchronizing toothed shafts work together optimally with our extensive and complete range of timing belts. Together they are a perfectly matched system for your application.

We have a large range of standard pulleys on stock, which can be reworked according to your specifications within a short time (e.g. bores and machining based on your drawings).

Special surface coatings, e.g. such as hard coating, anodizing, zinc coating or bronzing, improve corrosion and wear resistance (see page 75).

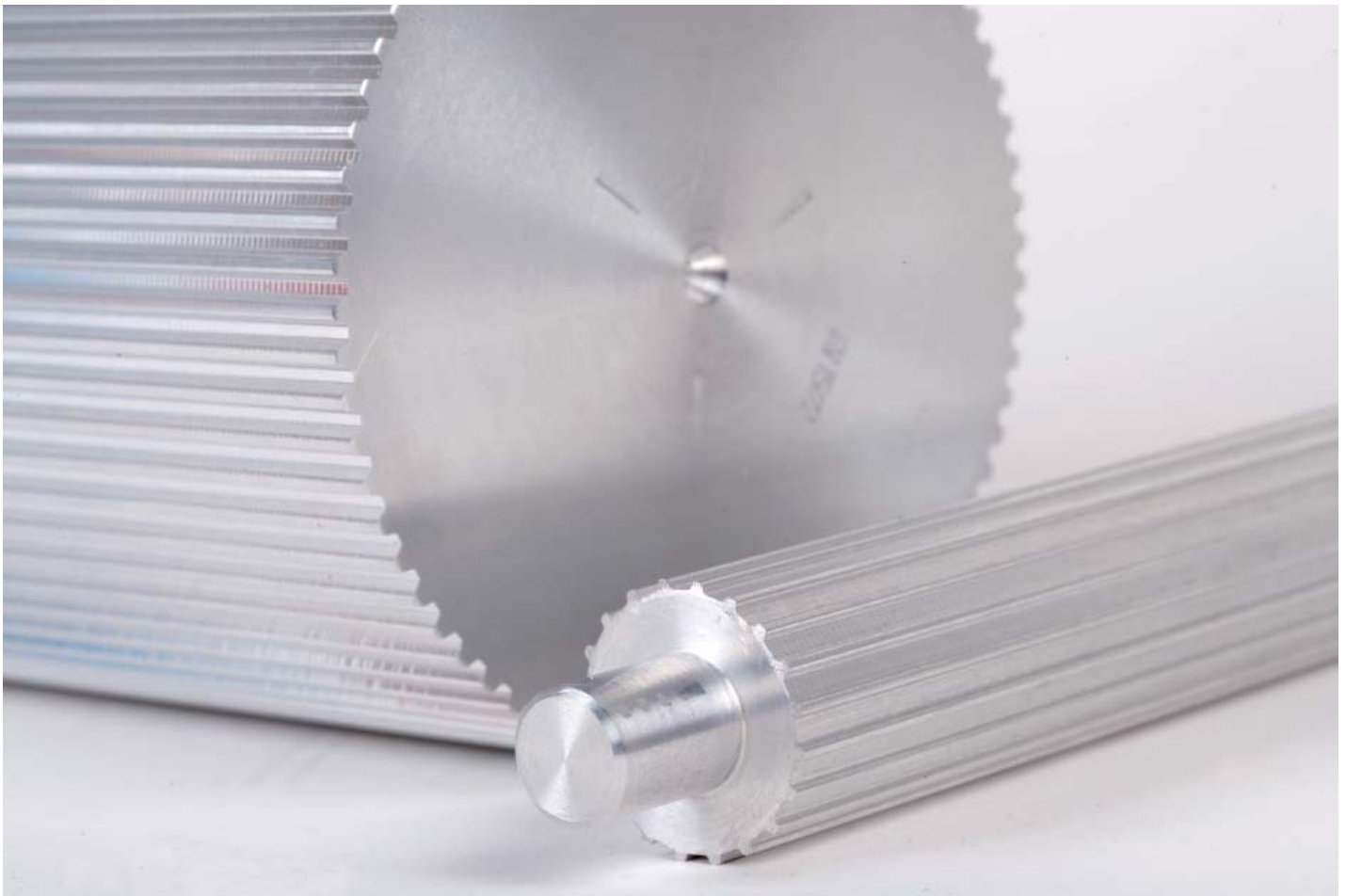



Standard synchronizing toothed shafts

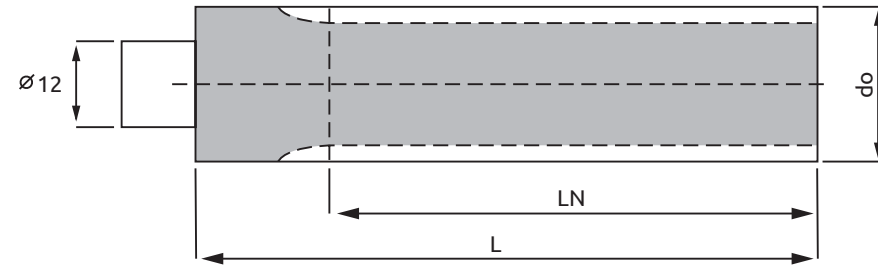

z = Number of teeth
dk = Outside diameter
do = Pitch circle diameter

XL (T1/5") pitch 5,08 mm

z	Material	dk (mm)	do (mm)	LN (mm)	L (mm)
10	St	15.66	16.17	125	140
11	St	17.28	17.79	125	140
12	St	18.90	19.40	125	140
13	St	20.51	21.02	125	140
14	St	22.13	22.64	132	140
15	St	23.75	24.26	132	140
16	St	25.36	25.87	140	140
17	St	26.98	27.49	140	140
18	St	28.60	29.11	140	140
19	St	30.21	30.72	140	140
20	St	31.83	32.34	140	140
21	St	33.45	33.96	160	160
22	St	35.07	35.57	160	160
23	St	36.86	37.19	160	160
24	St	38.30	38.81	160	160
25	St	39.92	40.43	160	160
26	St	41.53	42.04	160	160
27	St	43.15	43.66	160	160
28	St	44.77	45.28	160	160
29	St	46.38	46.89	160	160
30	St	48.00	48.51	160	160
32	Al	51.24	51.74	160	160
33	Al	52.85	53.36	160	160
34	Al	54.47	54.98	160	160
35	Al	56.09	56.60	160	160
36	Al	57.70	58.21	160	160
38	Al	60.94	61.45	160	160
39	Al	62.55	63.06	160	160
40	Al	64.17	64.68	160	160
41	Al	65.79	66.30	160	160
42	Al	67.40	67.91	160	160
43	Al	69.02	69.53	160	160
44	Al	70.64	71.15	160	160
48	Al	77.11	77.62	160	160
56	Al	90.04	90.55	160	160
60	Al	96.51	97.02	160	160
72	Al	115.92	116.43	160	160

L (T3/8") pitch 9,525 mm

z	Material	dk (mm)	do (mm)	LN (mm)	L (mm)
10	St	29.56	30.32	140	140
11	St	32.59	33.35	140	140
12	St	35.62	36.38	160	160
13	St	38.65	39.41	160	160
14	St	41.68	42.45	160	160
15	St	44.72	45.48	160	160
16	St	47.75	48.51	160	160
17	St	50.78	51.54	160	160
18	St	53.81	54.57	160	160
19	St	56.84	57.61	160	160
20	St	59.88	60.64	160	160
21	St	62.91	63.67	160	160
22	St	65.94	66.70	160	160
23	St	68.97	69.73	160	160
24	St	72.00	72.77	160	160
27	St	81.10	81.86	160	160
30	St	90.20	90.96	160	160



T5 pitch 5 mm

z	Material	dk (mm)	do (mm)	LN (mm)	L (mm)
10	Al	15.05	15.92	125	140
11	Al	16.65	17.51	125	140
12	Al	18.25	19.01	125	140
13	Al	19.85	20.70	125	140
14	Al	21.45	22.28	132	140
15	Al	23.05	23.87	132	140
16	Al	24.60	25.46	140	140
18	Al	27.80	28.65	140	140
19	Al	29.40	30.24	140	140
20	Al	31.00	31.83	160	160
21	Al	32.70	33.42	160	160
22	Al	34.25	35.12	160	160
23	Al	35.85	36.61	160	160
24	Al	37.40	38.20	160	160
25	Al	39.00	39.79	160	160
26	Al	40.60	41.47	160	160
27	Al	42.20	42.97	160	160
28	Al	43.75	44.62	160	160
29	Al	45.35	46.17	160	160
30	Al	46.95	47.75	160	160
32	Al	50.10	50.94	160	160
34	Al	53.25	54.13	160	160
35	Al	54.85	55.72	160	160
36	Al	56.45	57.30	160	160
37	Al	58.05	58.90	160	160
38	Al	59.65	60.50	160	160
40	Al	62.85	63.66	160	160
42	Al	66.00	66.87	160	160
44	Al	69.20	70.07	160	160
45	Al	70.80	71.64	160	160
46	Al	72.40	73.23	160	160
48	Al	75.55	76.42	160	160
50	Al	78.75	79.60	160	160
60	Al	94.65	95.52	160	160
72	Al	113.75	114.62	160	160
80	Al	126.48	127.36	160	160
90	Al	142.40	143.28	160	160
100	Al	158.31	159.20	160	160

T10 pitch 10 mm

z	Material	dk (mm)	do (mm)	LN (mm)	L (mm)
11	Al	29.98	31.83	140	140
12	Al	33.16	35.01	140	140
12	Al	36.35	38.20	140	140
13	Al	39.50	41.38	140	140
14	Al	42.70	44.56	160	160
15	Al	45.90	47.75	160	160
16	Al	49.09	50.93	160	160
17	Al	52.25	54.11	160	160
18	Al	55.45	57.30	160	160
19	Al	58.65	60.48	160	160
20	Al	61.80	63.66	160	160
21	Al	65.00	66.85	160	160
22	Al	68.20	70.03	160	160
23	Al	71.35	73.21	160	160
24	Al	74.55	76.39	160	160
26	Al	80.90	82.76	160	160
28	Al	87.25	89.13	160	160
30	Al	93.65	95.49	160	160
32	Al	100.00	101.86	160	160
34	Al	106.35	108.23	160	160
36	Al	112.75	114.59	160	160
38	Al	119.10	120.96	160	160
40	Al	125.45	127.32	160	160
45	Al	141.40	143.24	160	160
48	Al	150.95	152.79	160	160
60	Al	189.15	190.99	160	160
72	Al	227.35	229.18	160	160